

Alkaline Plus Filter Replacement Instructions

- 1 - Open filters' housing cover by unscrewing the 2 side-bolts
- 2 - Turn OFF water supply to the system and the tank ball valve.
- 3 - Turn ON filter faucet to release the pressure.
- 4 - Please note: ALL filter cartridges have a FLOW DIRECTION arrow which appears on the filter label. Please note the direction in order to re-connect the new filter in the correct direction.
- 5 - In order to remove each filter, find the plastic collet at the end of the cartridge. Push the collet IN with your finger tip and, using your other hand, pull the tubing out. See Fig. 1

Fig. 1

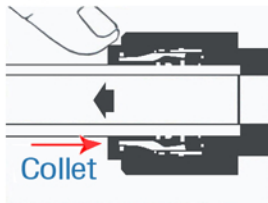

Fig. 1 Push in collet with finger tip and pull tubing.

- 6 - To reconnect the tubing to the new filter, simply push the tubing INTO the collet at the filter port. See Fig. 2

Fig. 2

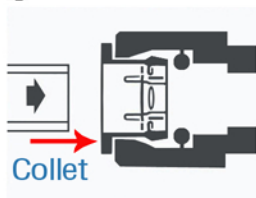

Fig. 2 Push tubing into the collet

- 7 - Remove SEDIMENT FILTER
- 8 - Using Steps 4 - 6, attach the new SEDIMENT FILTER.
- 9 - Remove PRE-CARBON filter.
- 10 - Repeat Steps 4 - 6 to attach the new PRE-CARBON filter.
- 11 - Remove the smaller POST CARBON filter.
- 12 - Repeat steps 4 - 6 to attach the new, smaller POST CARBON filter.
- 14 - Remove the blue PH Boost & Ionizing cartridge.
- 15 - Repeat steps 4 - 6 to attach the new blue PH Boost cartridge.
- 15 - TURN ON the water supply and TURN ON the tank BALL VALVE. Check for leaks.
- 16 - If there is a leak, locate its source and TURN OFF the water supply and TURN OFF the tank BALL VALVE. Make sure the tubing is securely inserted into each filter cartridge. Push it in again if necessary.
- 17 - TURN ON the water supply and the tank BALL VALVE.
- 18 - If the holding tank is full, water will immediately begin flowing from the faucet. If the tank is empty and water is needed immediately, allow the tank to fill for several minutes.. The tank will be fully charged providing a full flow after approximately one hour.
- 19 - Replace the filter housing using the two side-bolts.